

- ❶ = Boîtier de raccordement
- ❷ = Corps du luminaire
- ❸ = Tige
- ❹ = Câble d'alimentation
- ❺ = Cache
- ❻ = Accessoires de montage

**A.**

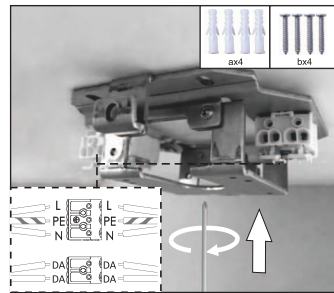

**B.** Dévisser le cache



**C.** Fixer la base  
Raccorder le câble d'installation

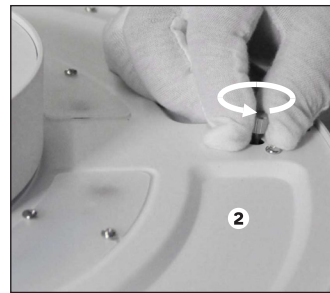

**D.** Dévisser les boutons

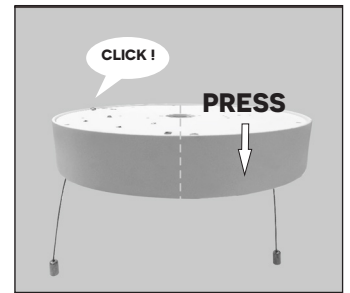

**E.** Presser les boutons

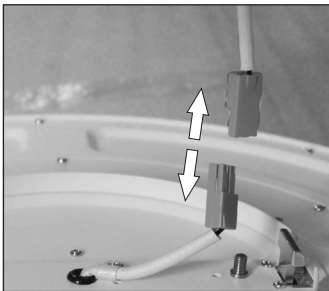

**F.** Débrancher le connecteur

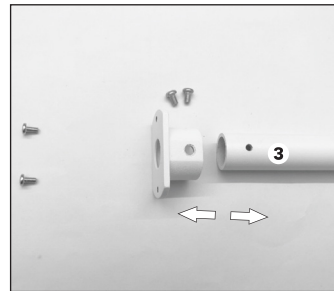

**G.** Dévisser

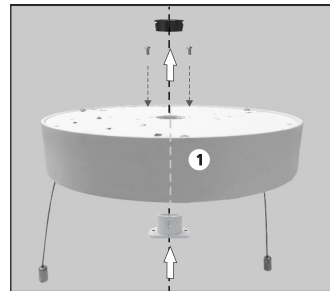

**H.** Fixer la base de la tige

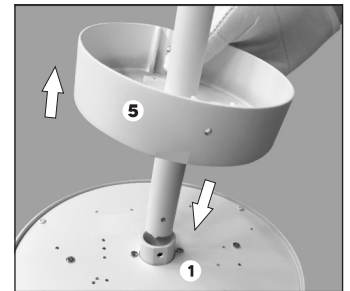

**I.** Placer la tige et le cache

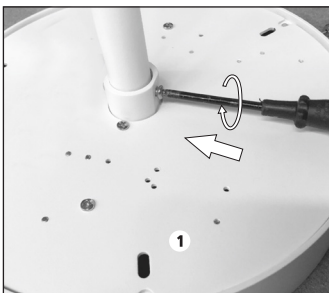

**L.** Visser la tige

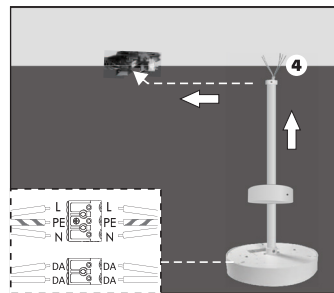

**M.** Raccorder le câble d'alimentation transparent

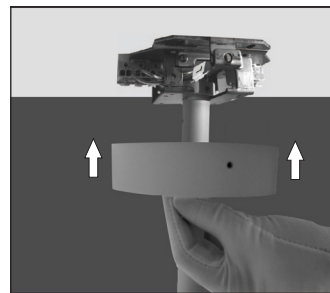

**N.** Glisser la tige dans son emplacement

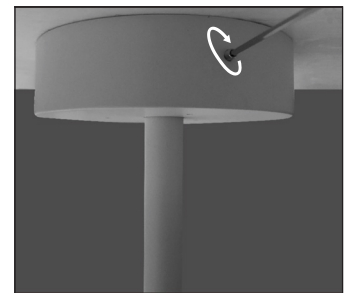

**O.** Visser le cache

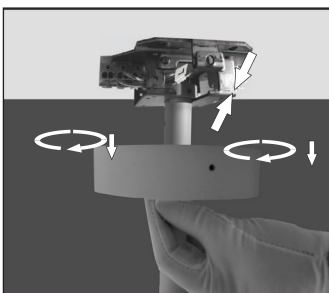

**P.** Visser les fils de sécurité  
Brancher le connecteur

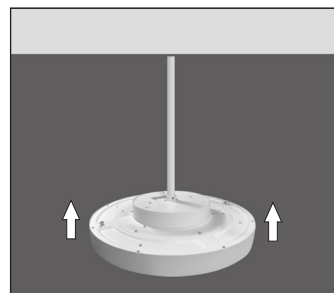

**Q.** Cliquer le luminaire au boîtier

